

# Caution

DO

NOT

Start motor on high

speed. Start motor on low speed and

gradually take it to a higher speed waiting 15-20  
seconds between increasing speed.

Running Extractor on high speeds can break new  
comb.

**DO NOT WASH WITH SOAP**

Please See PWRBA Policies and Guidelines

For Cleaning

**Equipment Reservations**

Chris Mayes  
cfmmayes@gmail.com  
or  
703-851-8830

**Mechanical Problems**

Chris Mayes  
cfmmayes@gmail.com  
or  
703-851-8830



PRINCE WILLIAM  
REGIONAL  
*Beekeepers*  
ASSOCIATION™  
Promoting Responsible and Sustainable Beekeeping  
**Honey  
Extraction Equipment  
Policies and Guidelines**

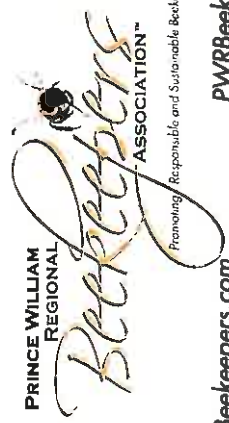

<http://www.PWRBeekeepers.com> [PWRBeekeepers@gmail.com](mailto:PWRBeekeepers@gmail.com)

\*Honey Blossom\* Cover photo Courtesy of National Honey Board

**Prince William Regional Beekeepers Association** owns honey extracting equipment: a manual 9 frame Maxant extractor, an uncapping hot knife and uncapping tank. **The extracting equipment use is FREE for the use of members only.**

Members borrowing the equipment will need to provide their own food grade 5 gallon honey bucket(s) to be placed under the extractor's honey gate.

### **Accountability and Care**

- The use of this equipment is a benefit of membership and is for *member use only*.
- Do not pass the equipment around to other beekeepers without prior approval, as you as the borrower are responsible for its condition.
- Handle with care
- Denis and scratches reduce the life and performance of the equipment.
- Protect all of the equipment from damage and excessive wear.
- Please report any mechanical problems **IMMEDIATELY**.
- The hot knife is extremely sharp and can get **VERY hot** ... use with care.

**Damaged equipment costs are the responsibility of the member borrowing the equipment.**

### **Borrowing Guidelines**

Due to high demand there is a maximum **two day** borrowing period. Equipment due back by 7 PM the last day of your turn.

### **Picking Up and Returning Equipment**

**Scheduling/Reservations** – Contact our equipment wrangler as listed on the back of this brochure. Equipment pickup time and location will be provided when reservations are confirmed.

- Due back by 7 PM of last day of use unless prior arrangements made.
- Please do not be late picking up or returning.
- The extractor is relatively large and moderately heavy. It comes in three pieces: the drum and two lids. The hot knife has a stand and box. Please return complete.

### **Cleaning Equipment**

The extractor and the knife must be cleaned and returned in working order. They must be returned clean and free of debris, dirt, honey, and wax as a courtesy to the next user.

### **How to Clean**

- **Do NOT disassemble the extractor to clean!**
- **Do NOT** use cleaning detergents as any residue will contaminate the honey.
- **Do NOT** submerge the knife in water or put it through your dishwasher!
- **DO Rinse** extractor and decapping tank thoroughly with **VERY HOT** water. Then spray with diluted bleach and water solution inside and out. **Rinse thoroughly again!** Return dry. (Bleach will dissipate when dried and aired out). The hot knife should be **UNPLUGGED** and warm for wipe down only.
- Return equipment as clean as when you picked it up.

### **Tips and Recommendations**

Consult your mentor if you are new to extracting.

Seek out online video instructions for harvesting and uncapping/extracting. There are many short videos on the internet, some better than others.

Brushy Mt. Webinar has a comprehensive video from on harvesting and extracting (about 1.5 hours long!) @ [http://www.brushymountainbeefarm.com/downloads/21July09\\_HarvestingExtracting.wmv](http://www.brushymountainbeefarm.com/downloads/21July09_HarvestingExtracting.wmv)

Be aware, the extracting process can be deliciously sticky and joyfully messy. It is recommended that your extracting area and supplies are setup in advance so you are organized and don't run out of time.

Be mindful that you are working with a food product and should be working in a clean area to prevent contaminating the honey.

Line the floor with a large sheet of plastic. Have a small dish pan type container available with warm water and a towel.

In lieu of using a cappings tank, use your own makeshift cappings tank; this will aid in clean up time.

The hotter the extracting area, the quicker the honey will extract from the frames (particularly important with our manual hand crank extractor).

Extract in an enclosed **bee free** area to prevent robbing frenzies. The bees **WILL** find you in **VERY** short order if you are outside!

Be mindful of extractor's honey gate position. The gate should always be open when extracting. **Always have a bucket under the honey gate!**

Moisture content – it is advised that you extract honey frames that are fully capped to ensure the honey's moisture content is correct (unless you have access to a refractometer).

Small Hive Beetle – remove honey no more than 2 days before extracting to avoid SHB eggs from hatching in the honey frames (this will spoil the honey!)

Keep an eye on the honey bucket level so as not to overflow.

If you intend to keep your wax cappings, freeze the wax to kill potential wax moth and SHB eggs.

Extracted honey **comb** is very valuable...protect it wisely ... Return it to the bees for clean up and reuse.





# Dadant

51 S. 2nd Street  
Hamilton, IL 62341  
217-847-3324  
1-888-922-1293

*Chico, CA Branch*  
530-893-0921  
1-877-332-3268

*Fresno, CA Branch*  
559-495-0230  
1-877-432-3268

*Sioux City, IA Branch*  
712-255-3232  
1-877-732-3268

*Paris, TX Branch*  
903-784-6145  
1-877-632-3268

*Albion, MI Branch*  
517-629-2860  
1-877-932-3268

*Watertown, WI Branch*  
920-261-5363  
1-877-232-3268\*

*Waverly, NY Branch*  
607-565-2860  
1-877-532-3268

*Lynchburg, VA Branch*  
804-846-0666  
1-800-220-8325

*High Springs, FL Branch*  
904-454-0237  
1-877-832-3268

\*Note: The Wisconsin toll-free number will be answered at the Dadant Corporate Office in Hamilton, IL

## Dadant M00401 Ranger Power Extractor



Assembly



Operation



Maintenance



Replacement Parts

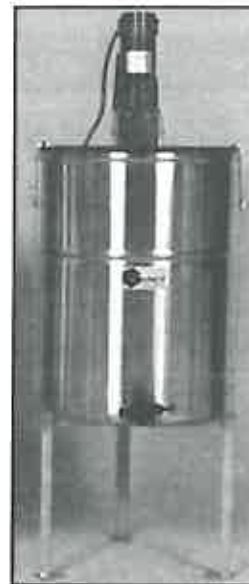

*Dadant  
Ranger Power  
Extractor*

- Extract 6—6 1/2" or shallower frames radially each load.
- Hand and electric power models
- Positive frame placement
- Specifically designed for honey producers using primarily 6 1/2" or shallower frames

- Stainless steel fabricated reel
- 18" stainless steel tank all welded
- 3 deep frames can be extracted tangentially with optional baskets.

## The Radial Extractor Concept

Radial extractors are the quickest, easiest, and most efficient way to extract honey from the comb. Uncapped combs are placed in the circular reel like spokes of a wheel with the frame top bars toward the outside of the reel. The reel spins, creating a centrifugal force. Because of the natural slant of the honeycomb cells, honey is thrown from both sides of the

comb at once. No further handling of the frames is needed from starting to unloading time, freeing the operator for other work such as uncapping combs for the next load. With radial extractors, the outward pressure is against the top bar, not against the comb surface as in small, non-radial models, eliminating much of the breakage of the combs.

# Operation

1. Frames of honey should have the cappings cut off both sides.
2. Place 6/ or smaller frames in reel frame pockets. Top bar of frame should rest against outer ring of reel with bottom bar toward the center shaft.



## Frame Top Bar

For deep frames see instructions packed with optional baskets.

3. After loading is complete, close lid and turn on motor using electronic speed control.

*Note: First year combs may require slower initial turning with gradual increases in speed. If you break combs slow down and increase speed gradually.*

**\*\*\*Most honey producers found that they can extract at full speed radially at the beginning. It's fast!\*\*\***

4. After extracting, your Ranger can be used as a 300# storage tank or bottling unit. Merely remove the three wing nuts holding the stationary lid and lift internal components from unit.

# Maintenance

1. The top bearing on the Ranger Power Extractor is a sealed bearing and requires **no** lubrication or maintenance.
2. Clean with soap and water and dry for storage between each use.

# Replacement Parts

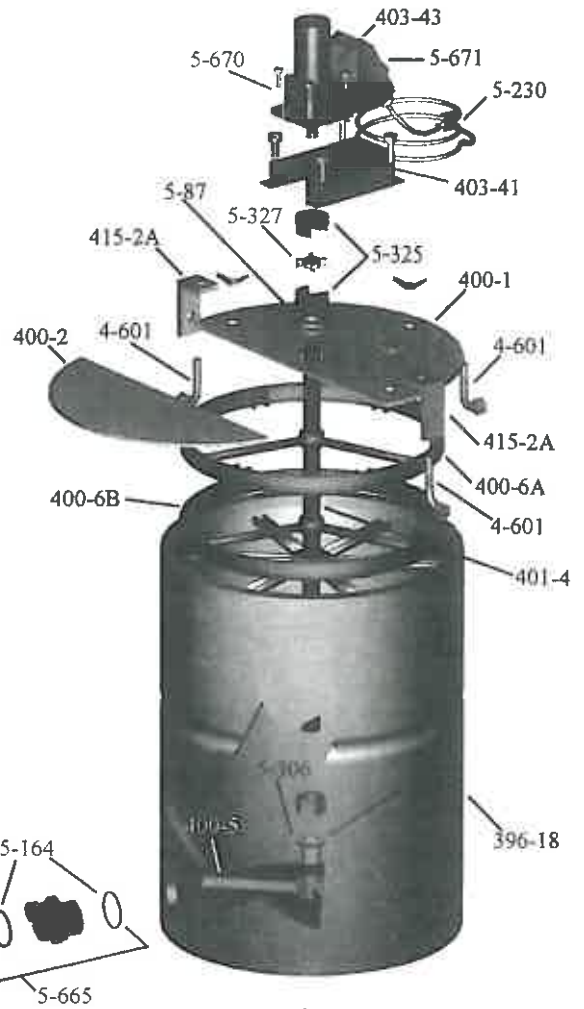

Dadant Ranger Power  
Extractor Replacement Parts  
Diagram

Part Number	Description	Part Number	Description
396-18	Tank	5-164	O-Ring (2)
400-1	Stationary Lid Half Assembly	5-670	Motor
400-2	Movable Tank Lid Assembly	5-230	Power Cord
400-5	Bottom Basket Support	5-671	Speed Control
400-6	Radial Reel	403-43	Speed Control Mount Bracket
401-4	Reel Shaft	5-306	1/2" x 5/8" Flanged Bushing
403-41	Motor Mount	5-665	Nylon Gate Assembly
415-2A	L-Bracket (2)	5-325	5/8" Shaft Coupling
4-601	L-Bolt Assembly (3)	5-327	Rubber Cross Only
5-87	Bearing w/Snap Ring		

## USA Parts Orders Only



51 S. 2nd Street  
Hamilton, IL 62341  
217-847-3324  
1-888-922-1293

Chico, CA Branch  
530-893-0921  
1-877-332-3268

Fresno, CA Branch  
559-495-0230  
1-877-432-3268

Sioux City, IA Branch  
712-255-3232  
1-877-732-3268

Paris, TX Branch  
903-784-6145  
1-877-632-3268

Albion, MI Branch  
517-629-2860  
1-877-932-3268

Watertown, WI Branch  
920-261-5363  
1-877-232-3268\*

Waverly, NY Branch  
607-565-2860  
1-877-532-3268

Lynchburg, VA Branch  
804-846-0666  
1-800-220-8325

High Springs, FL Branch  
904-454-0237  
1-877-832-3268

\*Note: The Wisconsin toll-free number will be answered at the Dadant Corporate Office in Hamilton, IL

# Dadant M00401

## Ranger Power Extractor

*“Superior Quality Stainless Steel Extractor”*

Stainless Steel 18" dia. tank. Strong-smooth welds provide excellent strength and superior quality allow a lifetime of service without leaks. Type 304 (24 Gauge .0235" thick) food grade stainless steel.

Strong-durable-quiet nylon gears need no oiling, providing years of trouble-free service.

1ft" Honey Gate, designed specifically for honey. Plastic gate has scissor action for clean cutoff.



Safety designed disengaging handle. Handle can be disengaged from turning mechanism while reel continues to turn.

Stainless Steel Reel (See detail below) fabricated and MIG welded for strength and reliability.

### Stainless Steel Stand-Optional

**M00397 stand provides positive extractor tie-down, clearance for a container, and easy cleanup.**

*Quality Standard Features Make The Difference*

#### Easy To Assemble

Easy-to-follow directions to assemble hand and lid assemblies to extractor unit.

#### Dimensions

18" (457.2 mm) diameter tank

29" (736.6 mm) overall height

On optional stand: 39" (990.6 mm) high.

#### Superior Welds

Tank has electronically controlled arc welds to give the best in quality—Smooth seams inside the tank clean easily and don't trap honey—**No Solder—No Sealants.**

#### All Food Grade Components

All stainless steel, aluminum, and nylon construction—No paint or plating to chip and peel with age and use—**No rust.**

#### Loading capacity

Six 6" or shallower frames or three standard deep frames per load when using optional basket.

#### Doubles as Storage Tank

After extracting, all internal components are easily removable to convert extractor into a 300-pound storage tank.

#### Hand Unit-Convertible to Power Unit

Equipment capacity can be increased as size of beekeeping operation increases by changing this unit into a power unit. Just ask for Ranger Hand to Power Conversion.

#### Optional Stand for Extractor

Provides cleaning space under extractor and gate height for 60-pound honey container. Dadant order number M00397.

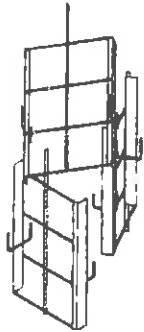

Insert optional baskets (M00402) to convert the Ranger into a 3-frame tangential for extracting deep frames.

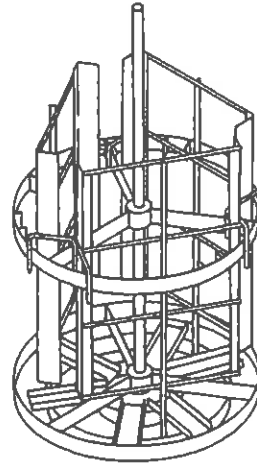

- Baskets are fabricated from 304 stainless steel.
- Baskets insert easily and positively.
- Baskets hook over outer ring of reel—no bolting, just set them in.

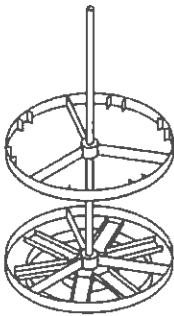

#### The Ranger Reel

- Stainless steel fabricated construction.
  - Positive frame "pockets" for 6—6" or shallower frames.
  - $\frac{5}{8}$ " stainless steel center shaft.
  - Easy (3 wing nuts)
- Removal for complete cleaning (See Right)

#### Removable Internal Components

Turn this extractor into a 300-pound storage tank by removing the wing nuts and lifting out the hand or power assembly, basket, and bottom basket support. It's a great way to bottle honey without extra equipment.

18" Storage Tank Cover Available—Dadant Order Number M00534

18" Strainer Screen Available—Dadant Order Number M00495

## Assembly

Except for mounting the power unit, the Little Wonder Power Extractor comes completely assembled.

1. Open the lid of the extractor and remove all packing holding the reel.
2. Completely wash and dry the unit before use.
3. Remove the power unit and fastener package from the separate carton.
4. Remove the tape from the extractor drive shaft coupling, keeping the rubber bushing in position.
5. Place the motor assembly on the stationary extractor lid aligning the bolt holes and the drive shaft coupling.
6. Remove fasteners from package and assemble as shown in the following diagram:

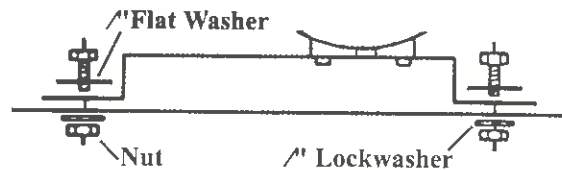

Check alignment of coupling and tighten mounting bolts.

7. Two L-brackets are supplied with the extractor to aid in securing the unit to the stand.

*Note: When extracting, all extractors should be tied down securely. An extractor stand (sold separately) allows the extractor to be firmly anchored to the floor and allows a 5 gallon pail to sit conveniently under the gate.*